

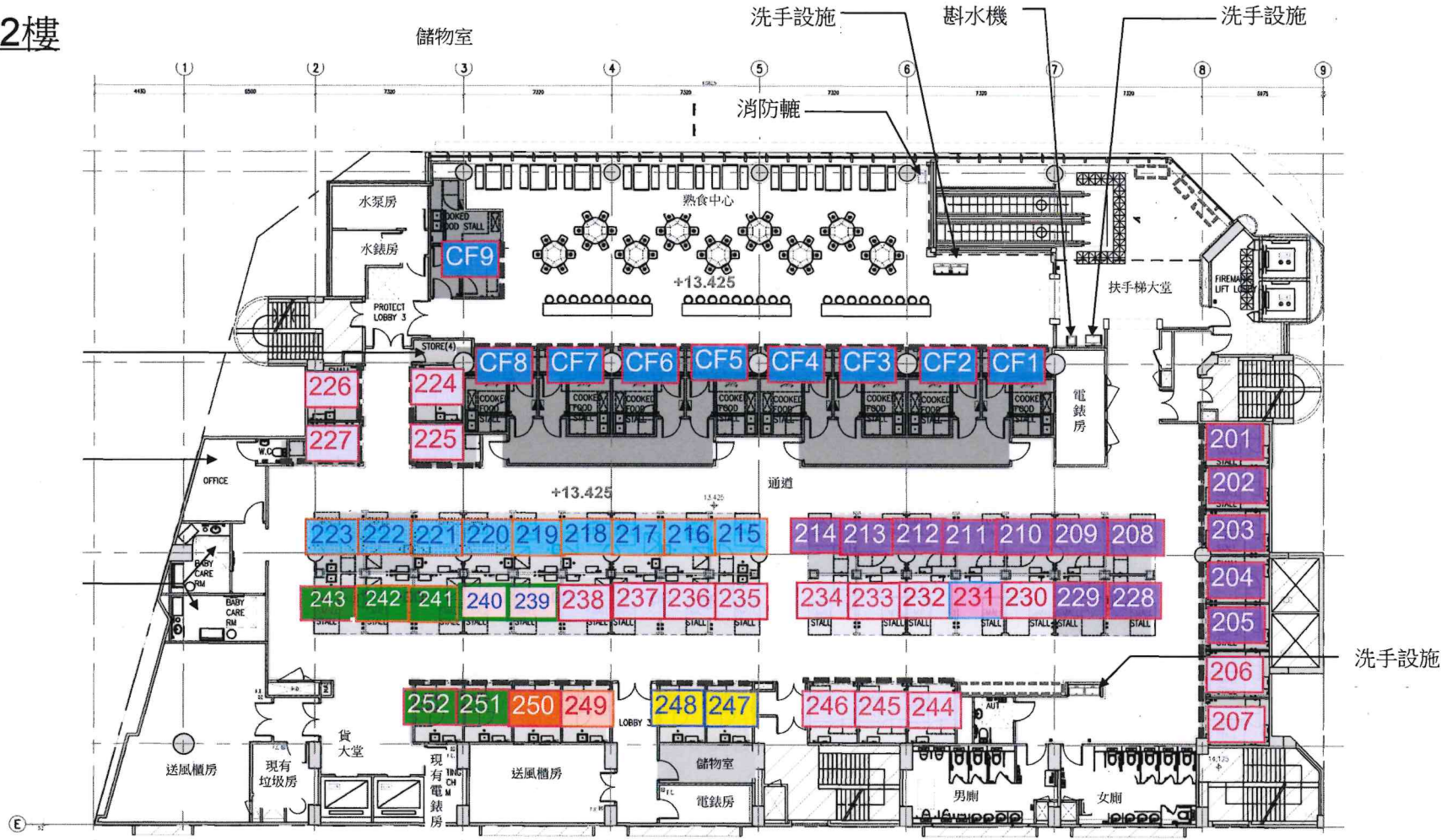









平面圖

2樓



- | | | | |
|--|--|--|--|
|  熟食 |  食物類乾貨 |  非食物類乾貨 (家品) |  非食物類濕貨 (鮮花/盆栽/觀賞魚及其用品) |
|  即食食物 |  非食物類乾貨 |  非食物類乾貨 (五金/鎖匠) | |
|  水果 |  非食物類乾貨 (寵物用品及寵物食品) | | |
| |  非食物類乾貨 (手機/手機配件/電子產品/電子零件) | | |